

Part number:

**HYDROMA**  
HYDRAULICKÉ SYSTÉMY

**HIDROMA**  
SYSTEMS  
UKŁADY HYDRAULICZNE

**HYDROMA**  
ГИДРАВЛИЧЕСКИЕ СИСТЕМЫ

# T-27J



0.00



Code **267**

	[kg]	21		[l]	1.2
--	------	----	--	-----	-----

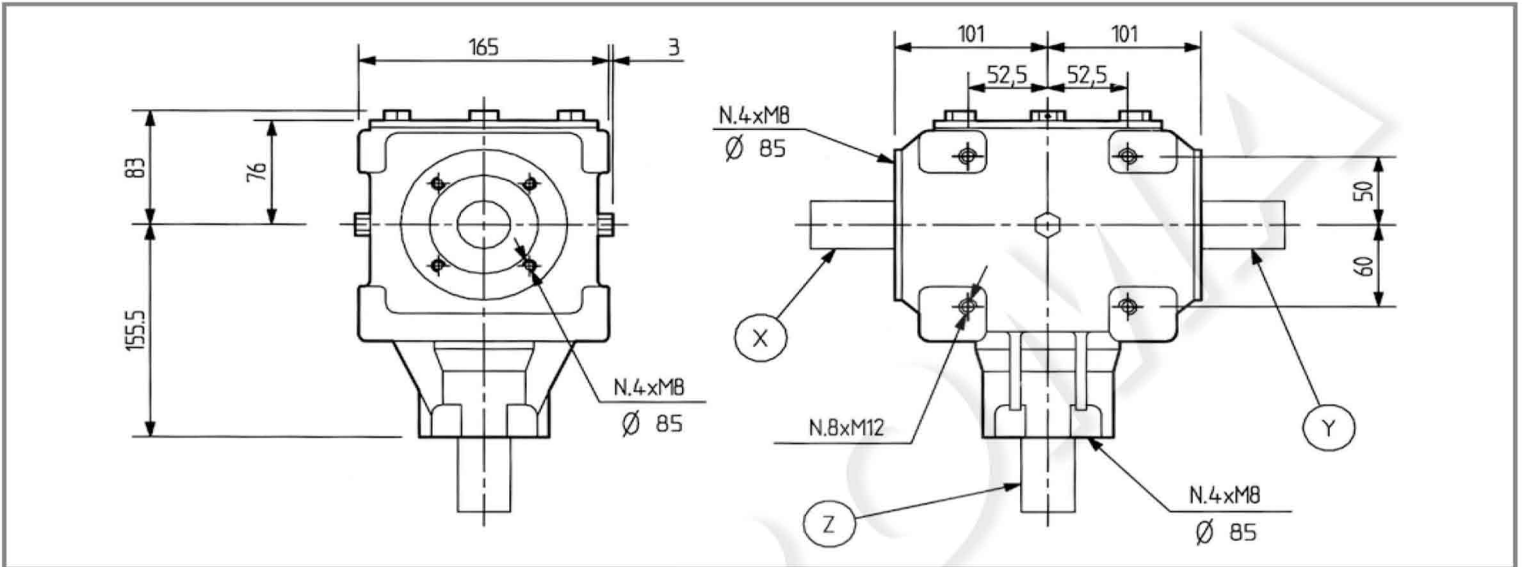

	i				std spec	Input	
		rpm	kW	HP	Nm	lb.in.	
—	1.00	540	28.0	38.0	479	4435	std Z 1-2 / 3-4 / 5-6
M	1.46		30.9	42.0	366	3357	X-Y-Z 21-22 / 23-24 / 25-26 / 33-34
	1.92		22.1	30.0	197	1824	std X-Y-Z 21-22 / 23-24 / 25-26 / 27-28
R	1.35		24.3	33.0	607	5623	Z 1-2 / 31-32
	1.46		29.4	40.0	736	6816	std Z 1-2 / 3-4 / 5-6
	1.46		15.1	20.5	496	4594	std X-Y-Z 11-12 / 13-14
	1.92						std X-Y-Z 1-2 / 3-4 / 5-6 / 11-12 / 13-14