

Part number:

**SOLENOID OPERATED VALVES
CONTINUOUS DUTY COILS - ED 100%**

DIN 43650 CONNECTORS

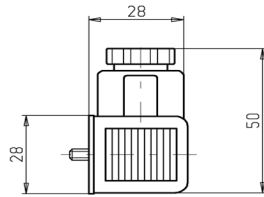

STANDARD CIRCUIT

ORDERING CODE **OD.01.01.01.00.00**

CIRCUIT WITH VDR

ORDERING CODE **OD.01.01.07.00 - Z**

Z	VOLTAGE
OB	12 V DC
OC	24 V DC

CIRCUIT WITH FULL WAVE RECTIFIER

ORDERING CODE **OD.01.01.02 - Y - Z**

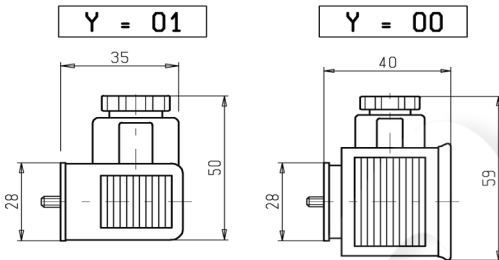

Y	DIODE CURRENT CAPACITY	
00	3 A	suitable for all coils
01	1 A	only for S8 coils

Z	VOLTAGE	INLET	RECTIFIED
OW	110 RAC	110 V AC	102 V DC
OZ	220 RAC	220 V AC	193 V DC

DESCRIPTION

These connectors are standardized according to DIN 43650 - ISO 4400.
They must be mounted with protection seals to obtain IP 65 protection class.

FEATURES

- | | | | |
|----------------------------|---------------------|-------------------------|----------------------|
| • Number of poles | 2 + Earth | • Cable gland thread | Pg 9 DIN 40430 |
| • Nominal current capacity | 10 A | • Tightening torque | 3 + 4 Nm |
| • Max. current capacity | 16 A | • Cable diameter | 6 + 8 mm |
| • Contact resistance | 4 mΩ | • Protection class | IP 65 DIN VDE 0580 |
| • Max. wire section area | 1.5 mm ² | • Electrical insulation | Class C DIN VDE 0110 |