

Part number:

**HYDROMA**

HYDRAULICKÉ SYSTÉMY

**HIDROMA  
SYSTEMS**

UKŁADY HYDRAULICZNE

**HYDROMA**

ГИДРАВЛИЧЕСКИЕ СИСТЕМЫ

<b>Portata max.</b> Max flow	<b>40 l/min</b>	<b>Codice</b> Code	<b>L 8 8 4 0 P M W X 0 0 0 Z</b>
<b>Pressione max.</b> Max oper. pressure	<b>250 bar</b>	<b>Modello</b> Model	<b>TI-VRP/T</b>
<b>Attacchi</b> Ports	<b>1/4" Gas</b>		
<b>Descrizione:</b> Testate intermedie con ritegno/i in linea (attacco pompa emergenza) <b>Description:</b> Intermediate slice with in line check valve(s) (emergency pump port)			

**SCHEMA****CIRCUIT**

Schema Circuit			
	<b>W</b>	<b>0P</b>	<b>0T</b>

**CARATTERISTICHE TECNICHE****TECHNICAL FEATURES**

<b>X</b>	Portata Massima Max flow l/min	Pressione Massima Max. operating pressure bar	Pressione di apertura Cracking pressure bar
<b>01</b>	40	250	0,5

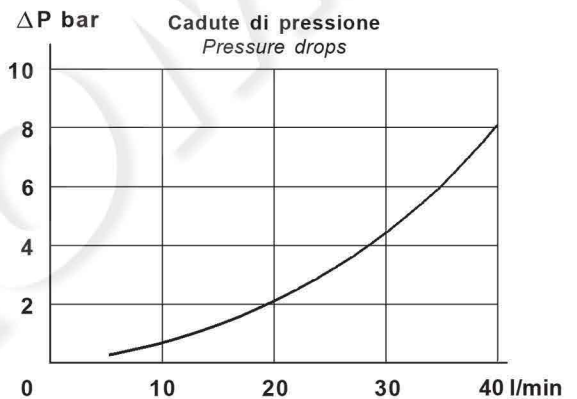

- Corpo alluminio EN-AW 2011-T6, anodizzato.
- Otturazione conico CA7.
- Aluminium body EN-AW 2011-T6, anodized.
- Poppet type CA7.

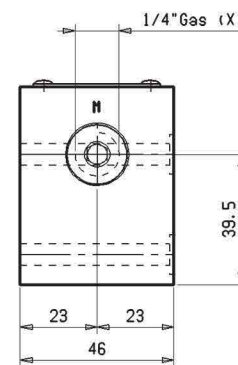
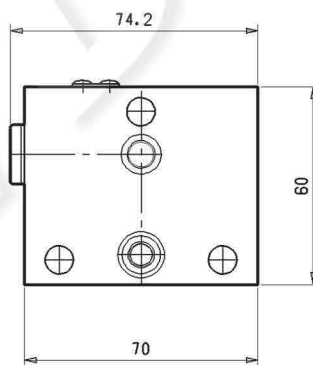
**DIMENSIONI DI INGOMBRO****OVER-ALL DIMENSIONS**

**Pesi**  
Weights

0,55 kg

**MOMENTI DI SERRAGGIO****TIGHTENING TORQUES**

**Elementi modulari**  
Stacking modules

N°4 DIN912-8.8 M5: 5÷6 Nm

**Raccordi sugli attacchi (X)**  
Fittings on ports (X)

35÷40 Nm

**ACCESSORI****OPTIONALS****Z** VERSIONE  
VERSION**0** STANDARD  
STANDARD**V** GUARNIZIONI IN VITON  
SEALS IN VITON