

Part number:

HYDROMA

HYDRAULICKÉ SYSTÉMY

**HIDROMA
SYSTEMS**

UKŁADY HYDRAULICZNE

HYDROMA

ГИДРАВЛИЧЕСКИЕ СИСТЕМЫ

STANDARD MANIFOLDS

3 WAY - 4 WAY ALUMINUM SIZE 06

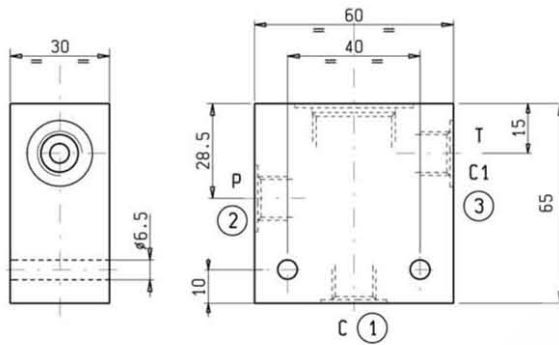

CAVITY **051-E**
Dimensions on page 7.01.11

ORDERING CODE	PORTS P-C-C1-T	WEIGHT Kg
OC.10.09.042	G 1/4	0.150
OC.10.09.048	G 3/8	0.150

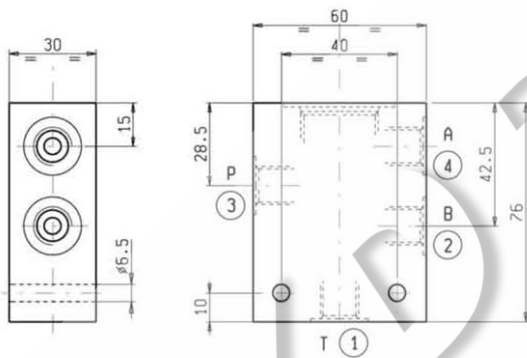

CAVITY **058-E**
Dimensions on page 7.01.12

ORDERING CODE	PORTS A-B-P-T	WEIGHT Kg
OC.10.09.047	G 1/4	0.150
OC.10.09.046	G 3/8	0.150

MAX. PRESSURE 250 bar

FEATURES

- Standard manifolds in high-strength aluminum TA-7020 for working pressures up to 250 bar.