

Part number:

HYDROMA

HYDRAULICKÉ SYSTÉMY

**HIDROMA
SISTEMS**

UKŁADY HYDRAULICZNE

HYDROMA

ГИДРАВЛИЧЕСКИЕ СИСТЕМЫ

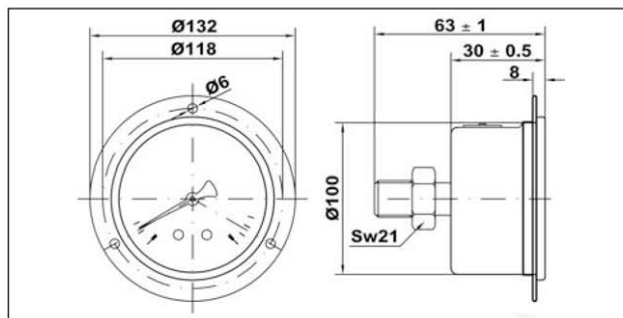
**MG3B-INOX 100****Opzioni : vedi pagina 114****Options : see page 114****Glicerina cassa inox DN100 attacco posteriore per montaggio a pannello con flangia 3 fori****Materiali**

Cassa + flangia 3 fori: Acciaio inox AISI 304 antiscoppio

Trasparente: Vedril PMMA

Quadrante: Alluminio bianco

Indice: Plastica nera

Attacco: Lega di rame lato quadro 21 mm, ≥ 40 bar foro di passaggio 0.5 mmElemento manometrico: Molla Bourdon in lega di rame, saldatura in lega di stagno ≤ 60 bar molla C, > 60 bar molla a ricciolo saldatura in lega Sn-Ag

Movimento: Lega di rame

Fluido antivibrante: Glicerolo 99.5%

Caratteristiche tecniche

Norme di riferimento: EN 837-1

Pressione d'esercizio: Statica: 75 % del valore di fondo scala

Fluttuante: 60 % del valore di fondo scala

Per brevi periodi: fino al valore di fondo scala

Limiti di temperatura: Ambiente: -20 ... +60 °C

Fluido: +40 °C massimo

Stoccaggio: -20 ... +60 °C

Deriva termica: $\pm 0,04\%/1$ Kelvin dello scostamento dalla temperatura di riferimento (+20°C)

Classe di precisione: cl. 1.6

Grado di protezione: IP 65 per EN 529 / IEC 529

Peso individuale: 0.585 kg

Glycerine filled stainless steel case DN100 centre back entry with 3-hole panel mounting flange**Materials**

Case + 3 hole flange: Stainless steel AISI 304 with blow-out device

Window: Vedril PMMA

Dial: White aluminium

Pointer: Black plastic

Pressure connection: Cu-alloy, 21 mm flats, ≥ 40 bar restrictor hole 0.5 mmPressure element: Bourdon tube Cu-alloy, soft soldered ≤ 60 bar C-type, > 60 bar helical type Sn-Ag soldered

Movement: Cu-alloy

Liquid filling: Glycerine 99.5%

Technical specifications

Design: EN 837-1

Working pressure: Steady: 75 % of full scale value

Fluctuating: 60 % of full scale value

Short time: full scale value

Temperature limits: Ambient: -20 ... +60 °C

Medium: +40 °C maximum

Storage: -20 ... +60 °C

Temperature effect: Deviation from reference temperature (+20°C): $\pm 0,04\%/1$ K of the span

Accuracy class: cl. 1.6

Degree of protection: IP 65 for EN 529 / IEC 529

Individual weight: 0.585 kg

Denominazione Type	Codice Part No.	Scala Pressure Range	Attacco Connection	Opzioni Options	Imballo/Conf. Box/Master	Min.ord. Min.order	€uro
MG3B-INOX 100		-76-0 cm Hg	G1/2B		1/10	10	
MG3B-INOX 100	PG509916LF	-1/0 bar/in Hg	G1/2B	D+LF*	1/10	1	
MG3B-INOX 100		-1/0.6 bar	G1/2B		1/10	10	
MG3B-INOX 100		-1+1.5 bar	G1/2B		1/10	10	
MG3B-INOX 100	PG5504DL01	-1+3 bar	G1/2B	D+LF+Z0*	1/10	10	
MG3B-INOX 100		-1+5 bar	G1/2B		1/10	10	
MG3B-INOX 100		-1+9 bar	G1/2B		1/10	10	
MG3B-INOX 100		-1+15 bar	G1/2B		1/10	10	
MG3B-INOX 100	PG540116LF	0-1 bar/psi	G1/2B	D+LF*	1/10	1	
MG3B-INOX 100	PG5402DL00	0-1.6 bar/psi	G1/2B	D*	1/10	10	
MG3B-INOX 100	PG550316LF	0-2.5 bar/psi	G1/2B	D+LF*	1/10	1	
MG3B-INOX 100	PG550416LF	0-4 bar/psi	G1/2B	D+LF*	1/10	1	
MG3B-INOX 100	PG550616LF	0-6 bar/psi	G1/2B	D+LF*	1/10	1	
MG3B-INOX 100	PG551016LF	0-10 bar/psi	G1/2B	D+LF*	1/10	1	
MG3B-INOX 100	PG551216LF	0-12 bar/psi	G1/2B	D+LF*	1/10	1	
MG3B-INOX 100	PG551616LF	0-16 bar/psi	G1/2B	D+LF*	1/10	1	
MG3B-INOX 100	PG552016LF	0-20 bar/psi	G1/2B	D+LF*	1/10	1	
MG3B-INOX 100	PG552516LF	0-25 bar/psi	G1/2B	D+LF*	1/10	1	
MG3B-INOX 100	PG554016LF	0-40 bar/psi	G1/2B	D+LF*	1/10	1	
MG3B-INOX 100	PG564416LF	0-60 bar/psi	G1/2B	D+LF*	1/10	1	
MG3B-INOX 100	PG564816LF	0-100 bar/psi	G1/2B	D+LF*	1/10	1	
MG3B-INOX 100	PG565416LF	0-160 bar/psi	G1/2B	D+LF*	1/10	1	
MG3B-INOX 100	PG566016LF	0-250 bar/psi	G1/2B	D+LF*	1/10	1	
MG3B-INOX 100	PG566216LF	0-315 bar/psi	G1/2B	D+LF*	1/10	1	
MG3B-INOX 100	PG566616LF	0-400 bar/psi	G1/2B	D+LF*	1/10	1	
MG3B-INOX 100	PG567016LF	0-600 bar/psi	G1/2B	D+LF*	1/10	1	