

Part number:

**HYDROMA**

HYDRAULICKÉ SYSTÉMY

**HIDROMA  
SISTEMS**

UKŁADY HYDRAULICZNE

**HYDROMA**

ГИДРАВЛИЧЕСКИЕ СИСТЕМЫ

## AMP Type

## Accumulator with exchangeable diaphragm

### Technical data

**Operating pressure:**  
**AMP 0.5** max 330 bar

**Gas filling (nitrogen only):** max. 90% of min. operating pressure

**Admissible pressure ratio:** max. 6/1

**Operating temperature:** -40 +150°C (Compatible with the temperatures admitted for the diaphragms)

**Mounting:** horizontal or vertical with gas valve upwards

### Standard construction characteristics

**Material of body:**  
**AMP 0.5** carbon steel

**Diaphragm:** according to fluid

**Gas connection valve:** 5/8"UNF version 1

**Painting:** anti-rust primer

**Test:** on request

3

### AMP 0.5

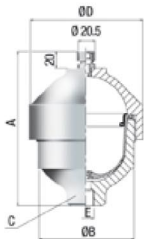

Tipo	Volume cm <sup>3</sup>	Pressione			Attacco lato liquido m	Valvola gas	Dimensioni mm				Peso kg
		max bar					A	ØB	C	ØD	
AMP 0.5	500.00	-	330	-	-	M18x1.5 Tappo M28x1.5 5/8"UNF	172	94	40	116	4.10