

Part number:

HYDROMA

HYDRAULICKÉ SYSTÉMY

**HIDROMA
SYSTEMS**

UKŁADY HYDRAULICZNE

HYDROMA

ГИДРАВЛИЧЕСКИЕ СИСТЕМЫ

PDM - PDT

Piastre per elettrovalvole LC 1 *Plates for solenoid valves LC 1*



CARATTERISTICHE TECNICHE

Grandezza: NG6 ISO 4401 - 03 CETOP RP121 H-03 (CETOP 3)

Disponibili con o senza valvola limitatrice di pressione

Versione in ghisa EN GJL 250

Versioni: singola, componibili e monoblocco.

Pressione max di lavoro: 310 bar

Circuiti in parallelo ed in serie

TECHNICAL CHARACTERISTICS

Size: NG6 ISO 4401 - 03 CETOP RP121 H-03 (CETOP 3)

Available with or without pressure relief valve

Version made in cast-iron EN GJL 250

Single, stacking and multielement plates version.

Max working pressure: 310 bar

Parallel and series circuits

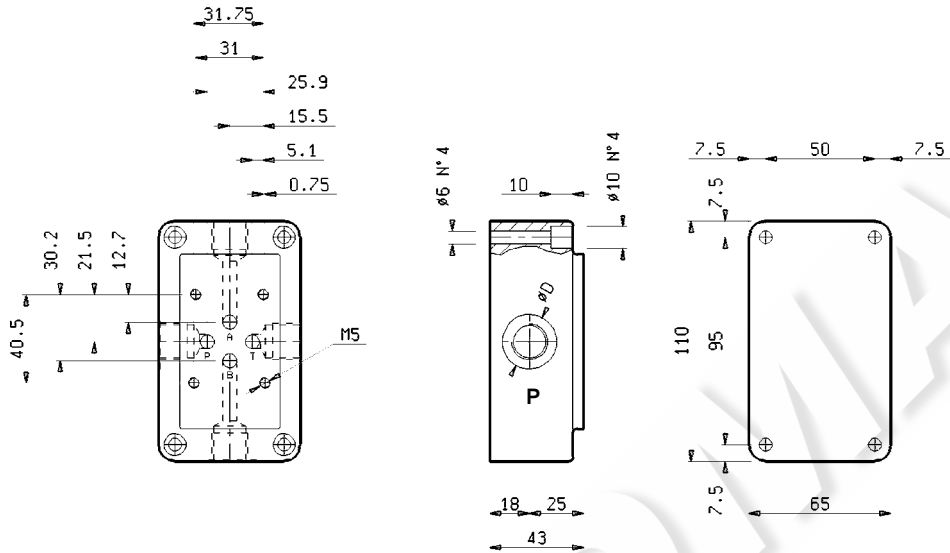

PIASTRA PER ELETTROVALVOLA SINGOLA MOUNTING PLATE FOR ONE SOLENOID VALVE

Codice · Code	Descrizione · Description	Attacchi · Ports	Peso · Weight
PDM121PLAT	Attacchi A-B-P-T laterali Side A-B-P-T ports	D = 3/8" Gas	1,80 kg

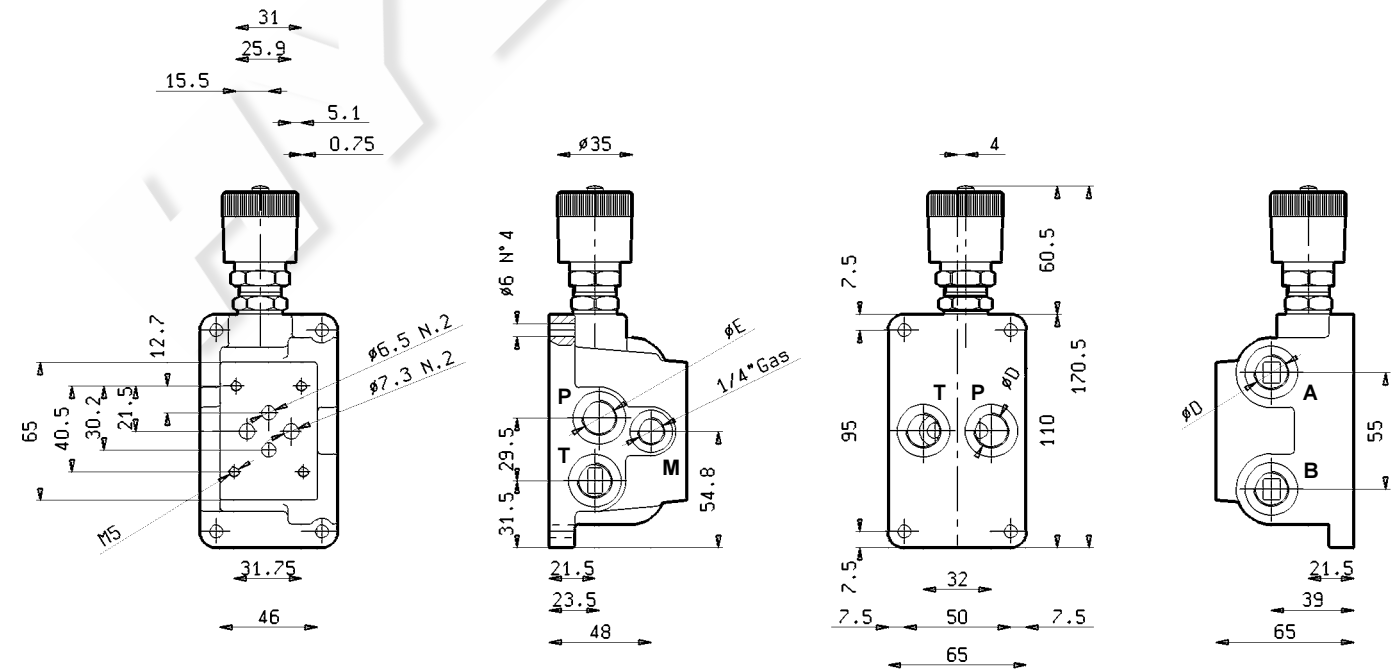

Codice · Code	Descrizione · Description	Attacchi · Ports	Peso · Weight								
PDM123 PDM123/1	Attacchi ABPTM laterali, PT supplementari inferiori con valvola limitatrice di pressione VM7 incorporata ABPTM side ports, PT supply rear ports with built-in pressure relief valve VM7	<table style="border: none;"> <tr> <td>Ø D</td> <td>Ø E</td> </tr> <tr> <td>3/8" G</td> <td>3/8" G</td> </tr> <tr> <td>1/2" G</td> <td>3/8" G</td> </tr> </table>	Ø D	Ø E	3/8" G	3/8" G	1/2" G	3/8" G	<table style="border: none;"> <tr> <td>2,94 kg</td> </tr> <tr> <td>2,89 kg</td> </tr> </table>	2,94 kg	2,89 kg
Ø D	Ø E										
3/8" G	3/8" G										
1/2" G	3/8" G										
2,94 kg											
2,89 kg											

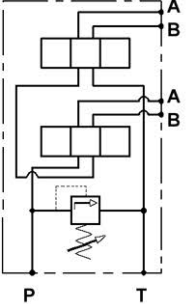

Codice · Code		X N. elettrovalvole n° of solenoid valve	PDT 180-190	PDT 181-191
PDT180/X SERIE PDT181/X SERIE PDT190/XW SERIE PDT191/XW SERIE			Ø D = 3/8" Gas Ø E = 3/8" Gas	Ø D = 1/2" Gas
Collegamento in serie Series connection		Con valvola limitatrice di pressione VM7 With pressure relief valve VM7	Peso Weight	Peso Weight
			kg	kg
	 (Vedi - See Pag.2.220.05)	2	4,63	4,57
		3	6,16	6,07
		4	7,69	7,57
		5	9,22	9,07
		6	10,75	10,57
		7	12,28	12,07
		8	13,81	13,57
		9	15,34	15,07
		10	16,87	16,57
		Senza valvola limitatrice di pressione Without pressure relief valve	2	4,58
	3		9,11	6,02
	4		7,64	7,52
	5		9,17	9,02
	6		10,70	10,52
	7		12,23	12,02
	8		13,76	13,52
	9		15,29	15,02
	10		16,82	16,52

**W VALVOLA LIMITATRICE DI PRESSIONE A CARTUCCIA
CARTRIDGE TYPE PRESSURE RELIEF VALVE**

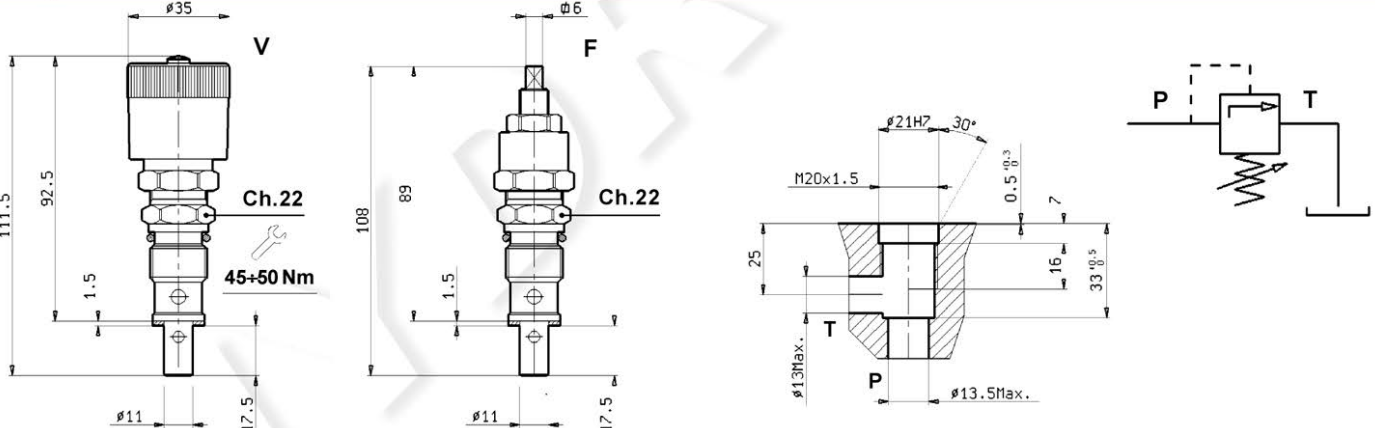

**Curve di apertura
Opening curves**

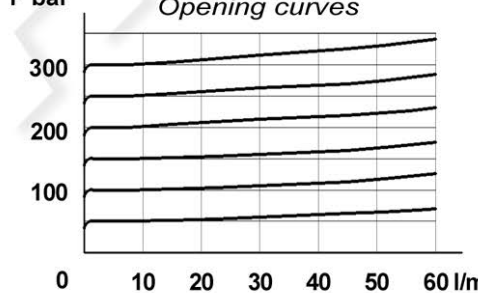

**Valore min di taratura
Min adjustable setting**

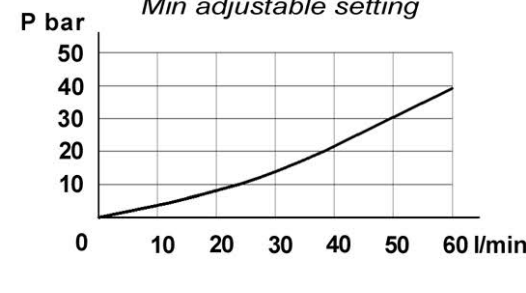

Tipo Type	Regolazione a volantino Knob adjustment	Regolazione a vite Screw adjustment	Portata Max. Max. flow l/min	Pressione Max. Max. pressure bar	Campo di taratura Pressure range bar	Cavità Cavity n°
VM7	0V	0F	60	310	0÷75	11
	1V	1F			15÷150	
	2V	2F			35÷210	
	3V	3F			120÷310	
	00				Senza valvola limitatrice - Without pressure relief valve	