

Part number:

**HYDROMA**

HYDRAULICKÉ SYSTÉMY

**HIDROMA  
SISTEMS**

UKŁADY HYDRAULICZNE

**HYDROMA**

ГИДРАВЛИЧЕСКИЕ СИСТЕМЫ

**EMERGENCY MANIFOLDS**

**2 WAY STEEL**

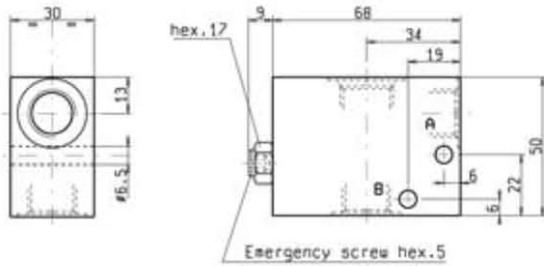

CAVITY **018-E**  
Dimensions on page 7.01.10

ORDERING CODE	PORTS A - B	WEIGHT Kg
OE.15.00.09.00.55	G 1/4	0.700
OE.15.00.02.00.55	G 3/8	0.700

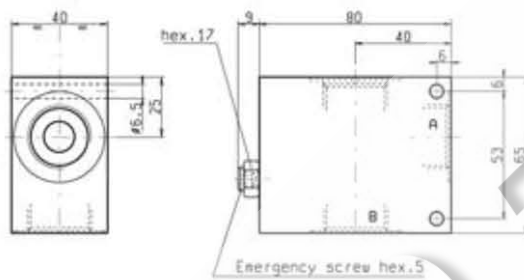

CAVITY **017-E**  
Dimensions on page 7.01.10

ORDERING CODE	PORTS A - B	WEIGHT Kg
OE.15.00.03.00.55	G 1/2	1.300
OE.15.00.04.00.55	G 3/4	1.300

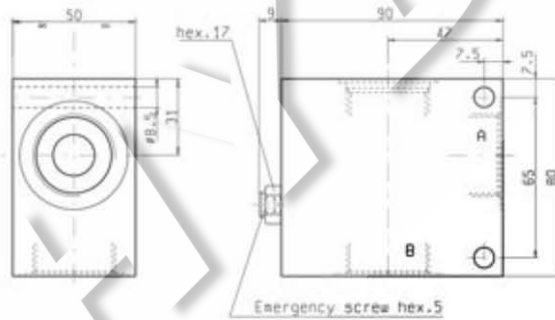

CAVITY **021-E**  
Dimensions on page 7.01.11

ORDERING CODE	PORTS A - B	WEIGHT Kg
OE.15.00.05.00.55	G 1	2.100

**MAX. PRESSURE 350 bar**

**FEATURES**

- These manifolds can be supplied upon request for working pressures up to 350 bar and for fatigue cycle applications.